

VESTA

VILLAS





When you traverse the globe sampling its best,
And only the finest offerings define your taste,
You should come home to nothing less.

Come home to Vesta.



DESIRED BY MANY, OWNED BY A FEW.

Reward yourself with a home set in Alibaug's most coveted 2.5 acres.

This home stands as an ode to you – a sanctuary that reflects you, your lifestyle and your accomplishments, throughout.

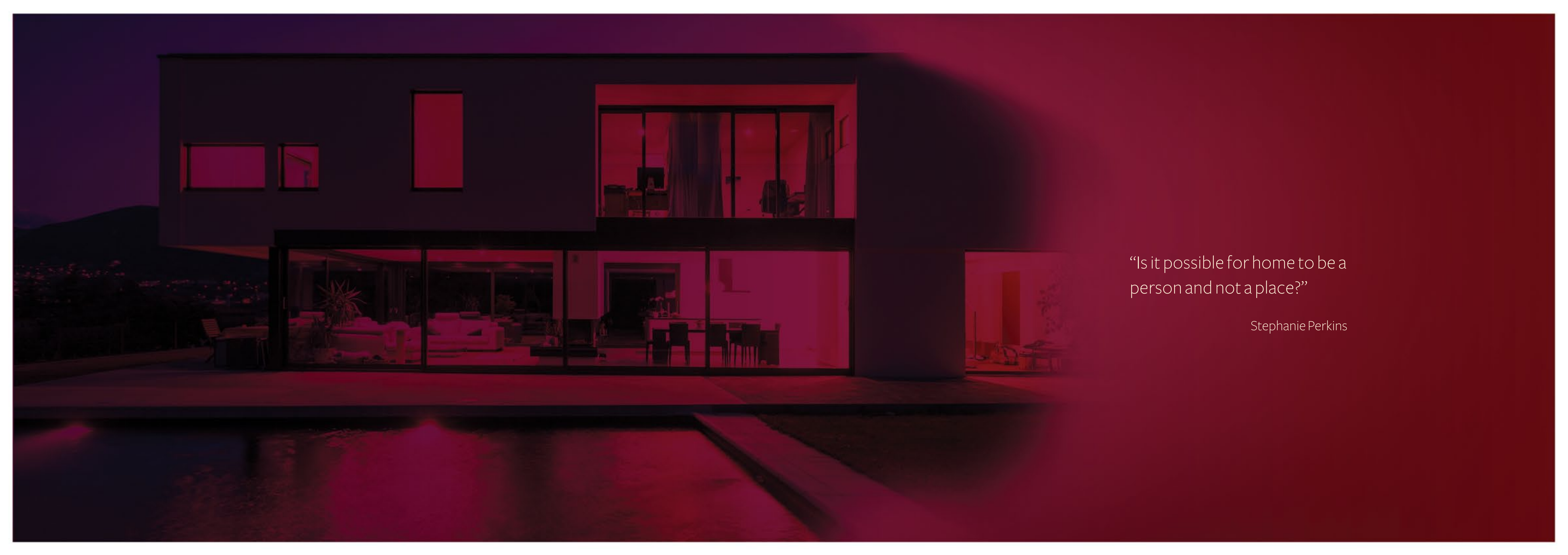

“Is it possible for home to be a person and not a place?”

Stephanie Perkins

CLOSE TO THE CITY AND YET
WORLDS AWAY

At Alibaug, you are greeted by the heady aroma of ocean air. Skyscrapers give way to green treetops. And the loudest sound you can hear is the call of songbirds.

Be transported to this beautiful land on a speedboat. With its undisturbed silence, it's hard to imagine you are only 20 minutes away from Mumbai.

- 20 mins speedboat ride from 'Gateway of India' to Mandwa Jetty
- 7 mins drive from Mandwa Jetty to Vesta Villas, Sasawane
- 10 mins walk towards Sasawane beach



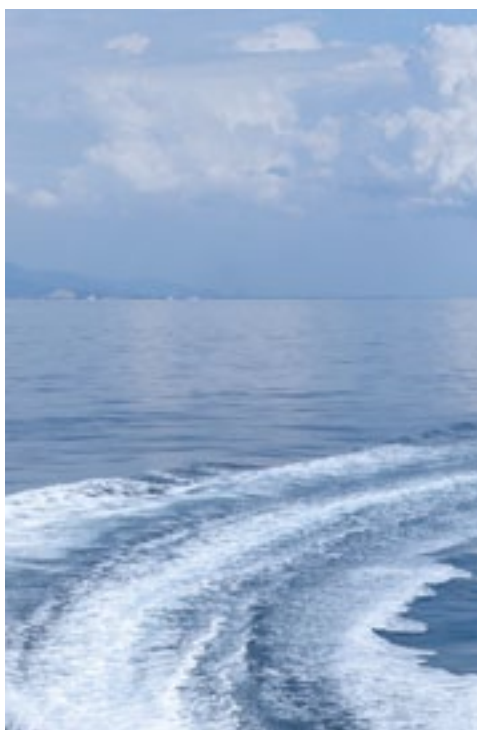

IN & AROUND VESTA

FEATURES

- Spread across approx. 2.5 acres
 - Exclusive luxury villa
 - Build-to-suit development
- Beautiful setting facing a natural pond

AMENITIES

- Private pool
- Beautiful poolside deck and sprawling lawns
 - Provision for jacuzzi
 - Provision for kitchen garden
 - Cabana in lawn
- Separate quarters for domestic help
 - 100% power back up

UNIQUE OFFERINGS

Option of:

- Shared ownership of speed boat
- Common security and property maintenance solutions
 - 24x7 surveillance system through your tablet

“Home isn’t a place, it’s a feeling”

Cecelia Ahern

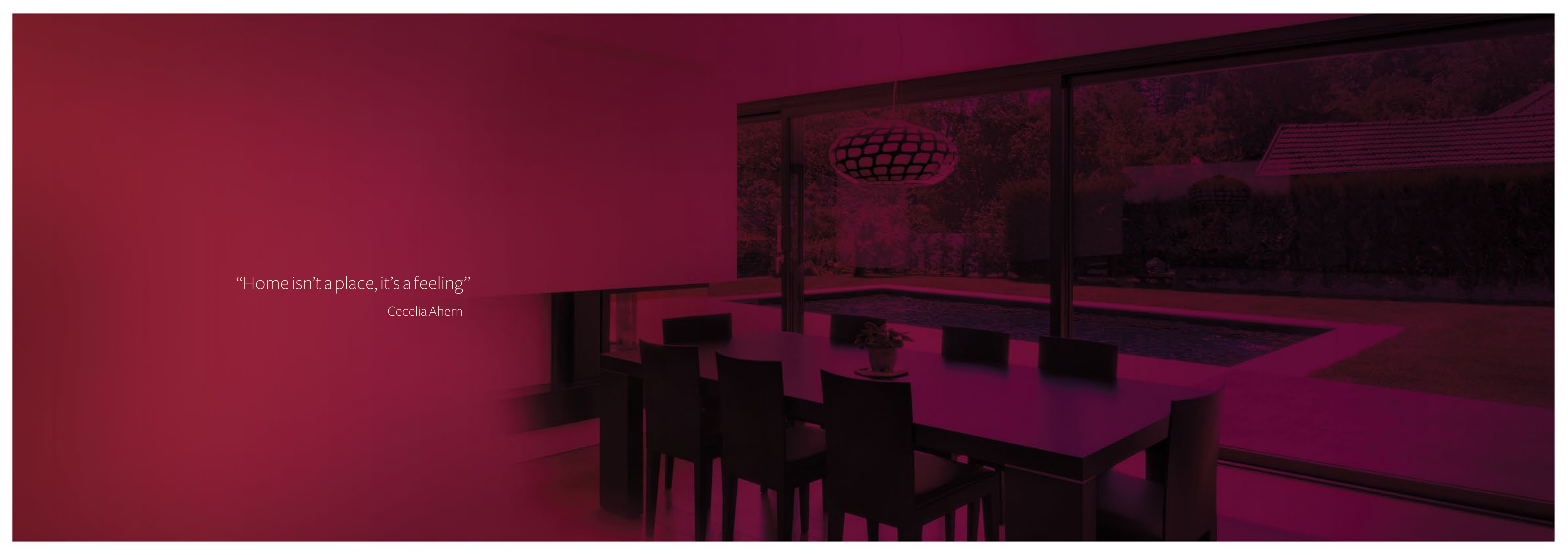



THE GRASS IS AS GREEN AS YOU WANT IT

Vesta comes with more than just a beautifully crafted residence. Here, you can create your home as per your personal tastes and preferences.

Whether you would like a library for your collection of hardbacks or French windows for your bedroom, our master builders will help realize your every whim.

LIVING SPACES

Nature is your constant companion at Vesta Villas.
The sights, sounds and the invigorating air are seamlessly integrated throughout your home.

Thoughtful attention to nuances further enhances the experience. For example, the layout planning ensures that one side of your villa enjoys maximum shade throughout the day, so that you can enjoy the outdoors to the fullest, even in peak summer.

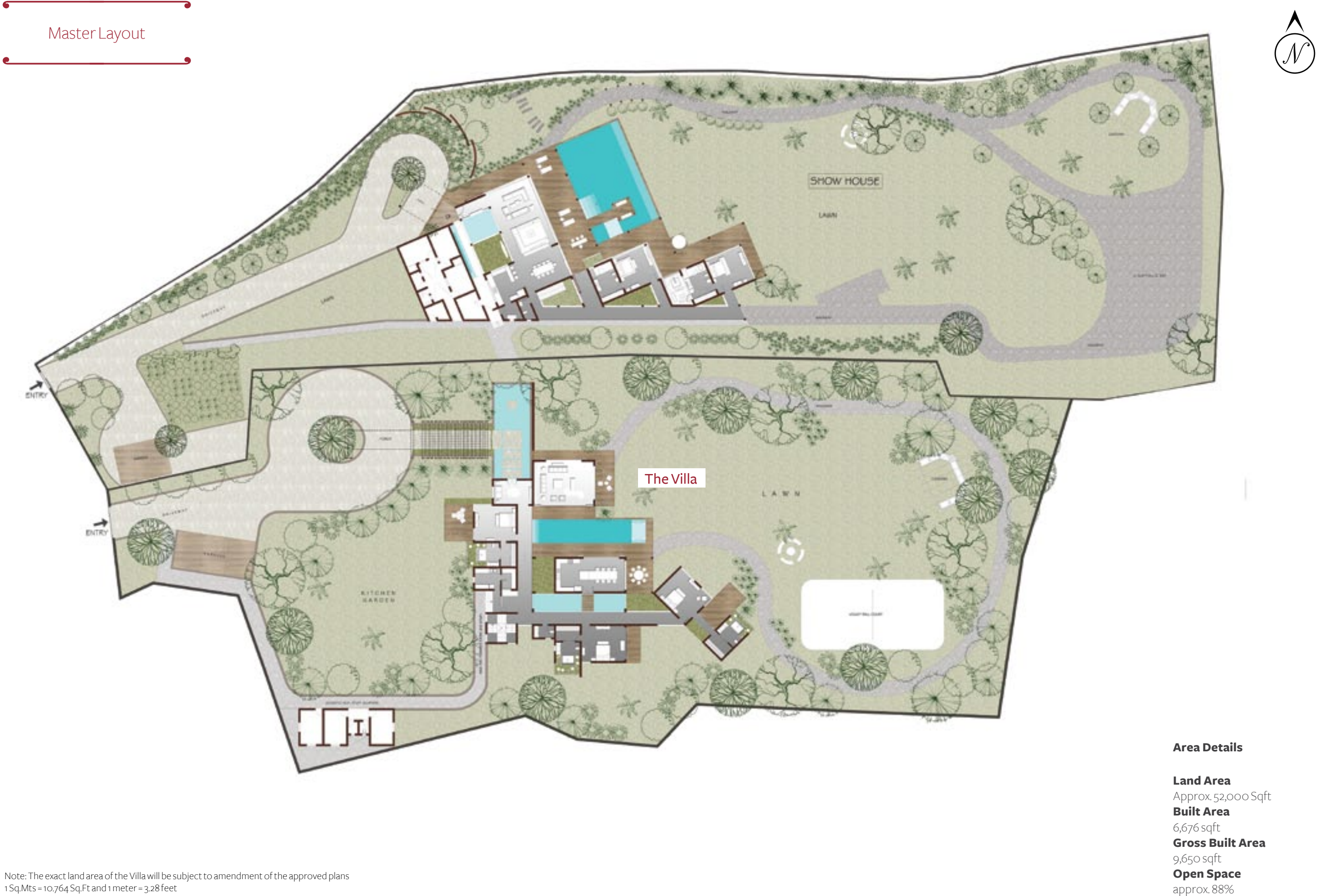



Artist's impression

The Villa

Ground Floor Plan



First Floor Plan





ECLECTIC HOMES

Our thoughtfully crafted villa is just the start.

Our team of architects will work to transform your space into a home built for luxury, lazing or whatever your heart desires.

And everything from the leg work to sourcing materials will be overseen by our experts.

Specifications

EXTERNAL DEVELOPMENT

- Main entrance gate
- Landscaped garden/lawn
- Garden pathway
- Provision for kitchen garden
- External garden lighting
- Cabana in the garden
- Readymade pool
- 100% power back up through DG
- Water supply and drainage system
- Common storm water system

BUILDING SPECIFICATION

- RCC structure
- RCC roofing system with Mangalore tile
- External painting in Apec Ultima/ rough cast sandfaced plaster finish or equivalent
- Water bodies and water carpets as per design

INTERNAL FINISHES

Flooring/Skirting/Toilet Dado

- Natural Indian stone for flooring and dado in Living Room/ Passage/ Dining/ Kitchen
- Kitchen dado in glossy finish vitrified tiles; 2 feet above the counter
- Laminated wooden flooring in family room
- Hardwood wooden finish deck in living room
- Wooden finished vitrified tile in all bedrooms
- Wooden finish vitrified tiles in all other decks/ balconies

Internal Paint Finish

- POP punning on walls
- Internal walls with luster paint of reputed make
- Ceilings with plastic emulsion paint of reputed make

Doors and Windows

- Main entrance in polished sleeper wood or equivalent
- Other rooms/ toilets with semi solid core flush doors with both the sides in laminate finish
- All room windows - Aluminium/ UPVC windows with glass and mosquito netting

Bathrooms

- Rustic finish vitrified tiles all bathrooms
- Dado in rustic finish designer ceramic tiles
- CP and sanitary fittings in Duravit/ Grohe/ Jaquar or equivalent
- Glass shower enclosure
- Water heater in all bathrooms

Electrical

- Concealed wiring with premium quality modular switches and provisions for fans
- Provision for internal light fixtures

Air Conditioning

- Provision for AC

UPGRADES

Walk-in Wardrobes - All Bedrooms

- Modular finish wardrobe with sliding shutters

Modular Kitchen

- Modular kitchen of reputed make

Home Automation

- 24 x 7 surveillance system through tablet

Pool

- Customised pool with mosaic tiles

- Jacuzzi as part of the pool

Air Conditioning

- High wall split unit in all rooms/ Living Room /Dining

Note: The specifications mentioned above are likely to change. These are indicative finishes represented to conceptualize the villas. This is not a legal offering.



Tomorrow. Today.

Ceeear Realty, headquartered in Mumbai, made an entry into the real estate business in 2013 under the leadership of Cherag Ramakrishnan, who has over 23 years of experience and is a veteran of the real estate sector.

Cherag Ramakrishnan has successfully set up and led Equinox Realty; the realty arm of Essar Group.

Under his leadership, Equinox Realty has created a portfolio of approximately 15 mn. sq. ft. across 6 states with a development outlay of approximately USD 600 mn and a team of up to 180 professionals. Presently, he continues to be Director at Equinox Realty.

Ceeear Realty will focus on projects spanning across asset categories. Under its present growth plans, it plans to develop Grade A projects in Bengaluru, Pune and Mumbai.

Ceeear Realty aims to be recognized as a prominent developer by virtue of its product quality and long-term approach.

About Consultants:
Architecture & Services: Patt & Panchal Associates, Mumbai
Structural Engineering: Kikani & Associates
Legal: to be decided

Corporate Office:
Unit No. 210, II Floor, Trade Centre, Bandra - Kurla Complex, Bandra (E),
Mumbai - 450051, India.

Regional Office:
Water's Edge, No.53/1, 54/1 & 55, Opp. Lumbini Gardens, Near Tata Motors, Outer
Ring Road, Nagavara, Bengaluru 560 045.

Our Projects



THE HAMLET, SADASHIV NAGAR, BANGALORE.



THE BIG TREE, JAYANAGAR, BANGALORE.



WATER'S EDGE, HEBBAL, BANGALORE.
(Development Management by Ceeear Realty)



Tomorrow. Today.

www.ceeaarrealty.com

Disclaimer: Information about the project is indicative of the kind of development that is proposed by the developer. Artist's impressions are used to illustrate some products and features. All plans, pictures and models herein are representative conceptions and not actual buildings or facilities. As such, the developer reserves the right to make changes or alterations, amend and vary the layout, plans, and specifications or feature at its own sole discretion without any obligations and/or any prior notice whatsoever, but subject to the approval of the competent authorities as applicable. The brochure does not constitute an offer and/or contract of any nature whatsoever. Any purchase/any legal agreement in any project shall be governed by the terms of the agreement entered into between the parties and no details mentioned on this brochure shall govern the transaction.